

# UNIVERSAL SHANK - INTERLOC SHANK ADAPTERS

\* Assemble with Master Flange \*  
 \* Assembles with IXS shanks \*

**"INTERLOC RIGID"**

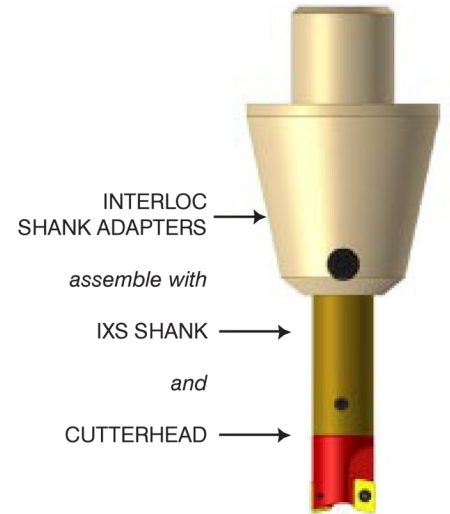
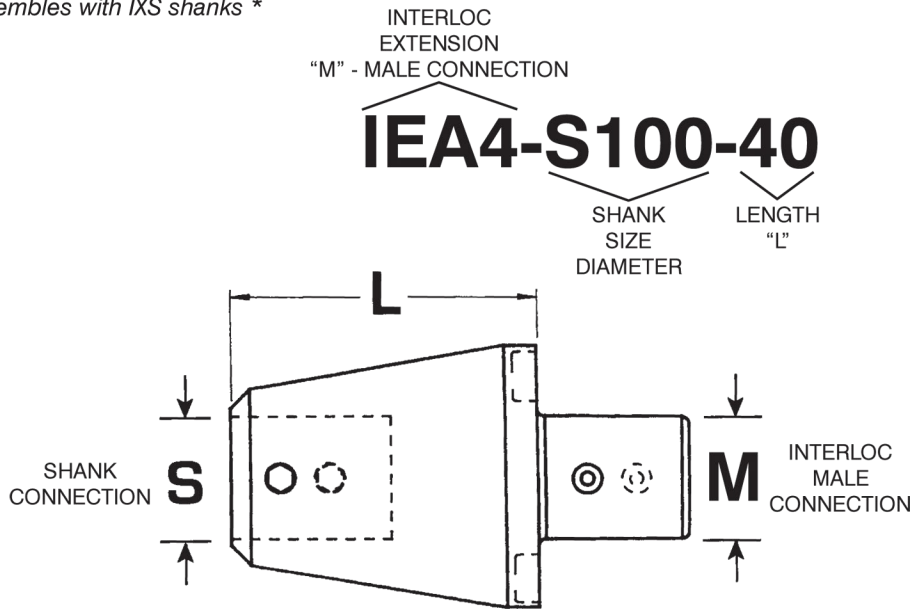

❖ Cooling through shanks available  
 ▲ Custom lengths available

## INTERLOC EXTENSION - INTERLOC SHANK ADAPTER

CATALOG NUMBER	INTERLOC MALE CONNECTION (M)	SHANK SIZE (S)	LENGTH (L)	LOCK SCREW NUMBER
IEA4-S100-40	M400 INTERLOC	1.000	4.000	TS-500
IEA4-S125-40		1.250		
IEA4-S200-40		2.000		TS-625S



Interloc Shank Adapter

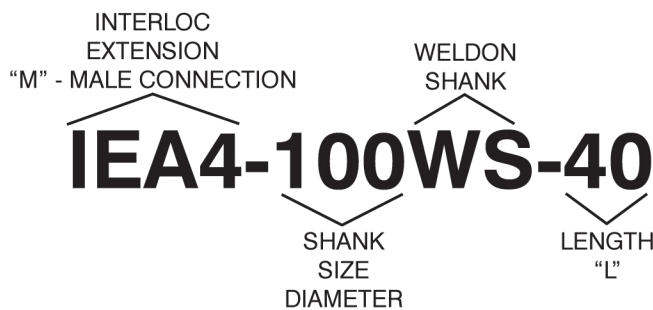

Weldon Flats Shank Adapter

## INTERLOC EXTENSION - WELDON FLATS SHANK ADAPTER

CATALOG NUMBER	INTERLOC MALE CONNECTION (M)	SHANK SIZE (S)	LENGTH (L)	ENDMILL SCREW NUMBER
IEA4-100WS-40*	M400 INTERLOC	1.000	4.000	TS-100E
IEA4-125WS-40*		1.250		
IEA4-200WS-40*		2.000		TS-200E

\*Semi-special

# INTERLOC-STRAIGHT SHANKS

\* Assembles with extensions, reducers, endmill holders and cutterheads \*

"INTERLOC DRIVE SYSTEM"



INTERLOC EXTENSION SHANK  
 STRAIGHT STYLE  
 LENGTH "L"  
**IXS-F75S-45U**  
 INTERLOC "F" - FEMALE CONNECTION  
 UNIVERSAL TOOL  
 • INTERLOC SHANK STYLE OR WELDON FLAT HOLDING

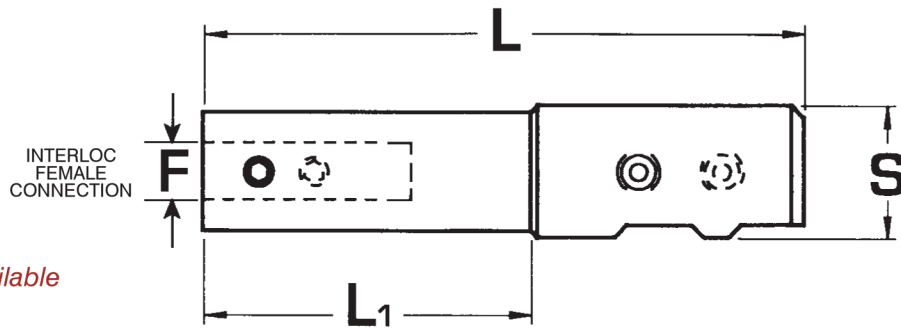
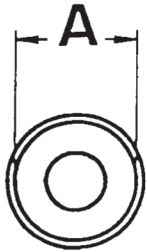
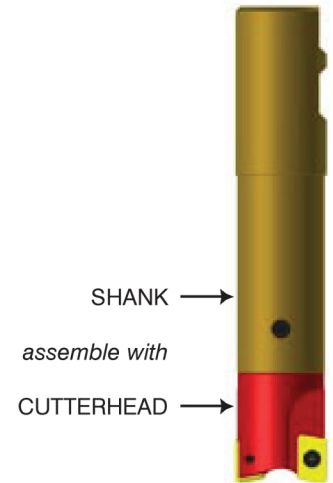

- ❖ Cooling through shanks available
- \* Semi-special
- ▲ Custom lengths available

CATALOG NUMBER	INTERLOC FEMALE CONNECTION (F)	DIAMETER (A)	SHANK DIAMETER (S)	LENGTH (L)	LENGTH (L1)	LOCK SCREW NUMBER	"T" HANDLE ALLEN WRENCH
IXS-F75S-35U*	F75 INTERLOC	.710	.750	3.500	1.200	TS-250S	1/8
IXS-F75S-45U				4.500	2.200		
IXS-F75S-575U				5.750	3.000		
IXS-F75S-75U				7.500	5.200		
IXS-F100S-35U*	F100 INTERLOC	.950	1.000	3.500	1.200	TS-516S	5/32
IXS-F100S-45U				4.500	2.200		
IXS-F100S-60U				6.000	3.500		
IXS-F100S-75U				7.500	4.500		
IXS-F125S-45U	F125 INTERLOC	1.200	1.250	4.500	2.200	TS-516	5/32
IXS-F125S-60U				6.000	3.500		
IXS-F125S-75U				7.500	4.750		
IXS-F125S-95U				9.500	6.500		
IXS-F200S-50U	F200 INTERLOC	1.900	2.000	5.000	1.700	TS-375	3/16
IXS-F200S-70U				7.000	3.700		
IXS-F200S-90U				9.000	5.700		

# INTERLOC-TAPER REACH SHANKS

\* Assembles with extensions, reducers, endmill holders and cutterheads \*

**"INTERLOC DRIVE SYSTEM"**

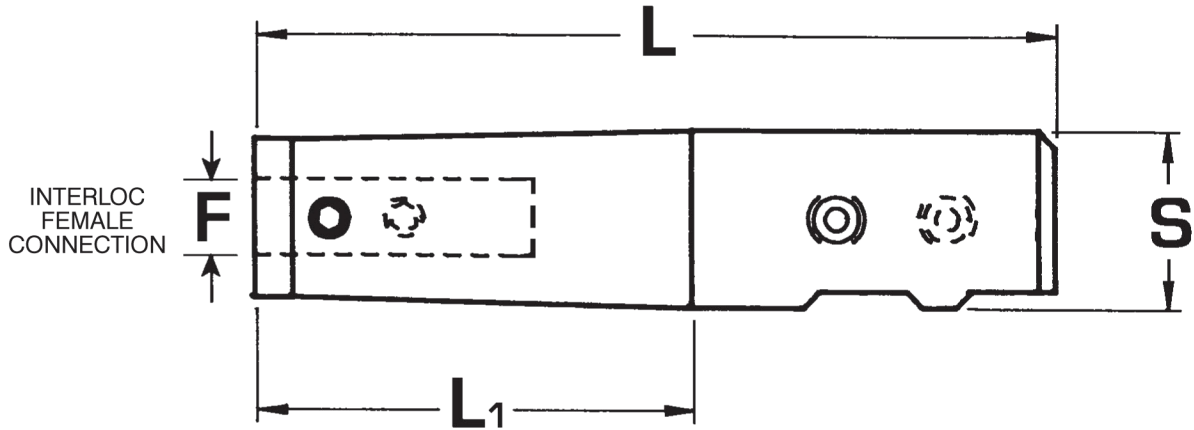
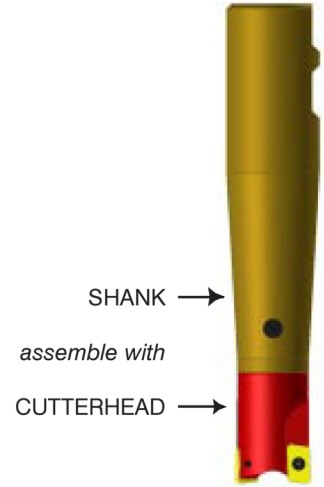
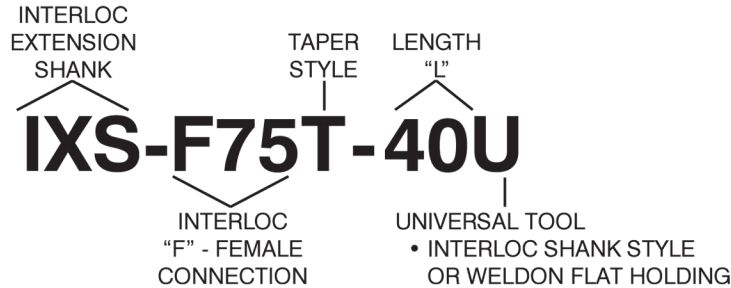

❖ Cooling through shanks available

▲ Custom lengths available

CATALOG NUMBER	INTERLOC FEMALE CONNECTION (F)	SHANK DIAMETER (S)	LENGTH (L)	LENGTH (L <sub>1</sub> )	LOCK SCREW NUMBER	"T" HANDLE ALLEN WRENCH
IXS-F75T-40U	F75 INTERLOC	1.000	4.000	1.750	TS-250S	1/8
IXS-F75T-50U			5.000	2.700	TS-250	
IXS-F75T-60U			6.000	3.500	TS-250S	
IXS-F75T-70U			7.000	4.650		
IXS-F75T-80U			8.000	5.650		
IXS-F100T-50U	F100 INTERLOC	1.250	5.000	2.600	TS-516	5/32
IXS-F100T-60U			6.000	3.400	TS-516S	
IXS-F100T-75U			7.500	4.800		
IXS-F100T-95U			9.500	6.650		