

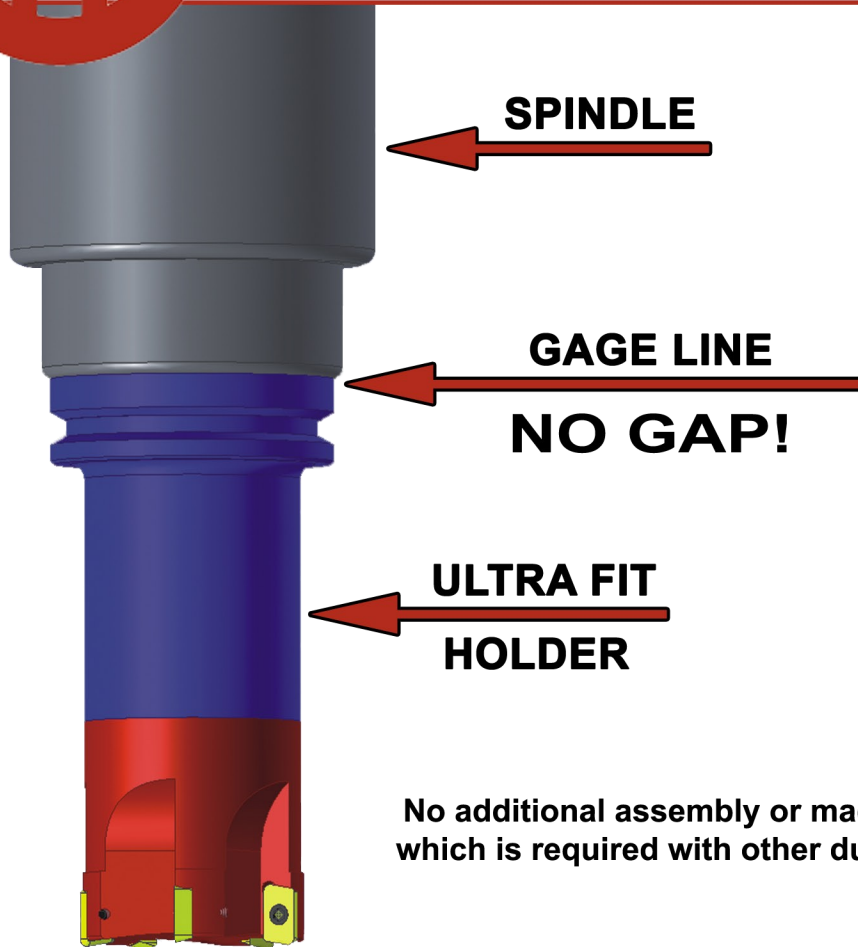

ULTRA FIT SYSTEM



No additional assembly or machining is needed on the spindle which is required with other dual contact holders in the market.

SOLID DUAL CONTACT

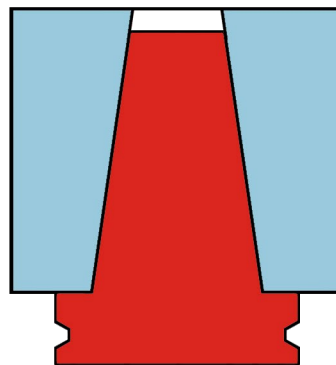

Automatically Adjusts
1/8" Spindle Gap Distance
Between Spindle Face
& Tool Holder

100% Contact With
Spindle Taper & Face

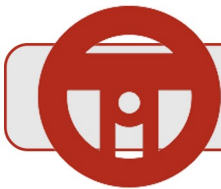

ULTRA FIT SYSTEM

The "ULTRA FIT" has been field tested and has provided exceptional and satisfying results to users nationwide. With the key benefit of leaving no gage line gap, it also allows the user to use these holders immediately with no aftermarket alterations or machining to their machine spindle.

The ULTRA FIT system will adapt by auto adjusting to your existing CAT spindle if it is within manufacturer's tolerances of $\pm 0.015"$ (.125" spindle gap variation already compensated in tool holder). As a result leaving no gage line gap between the spindle and holder and making your cutting tool extremely rigid. Plus no additional assembly or machining is needed on the spindle which is required with other dual contact holders in the market.

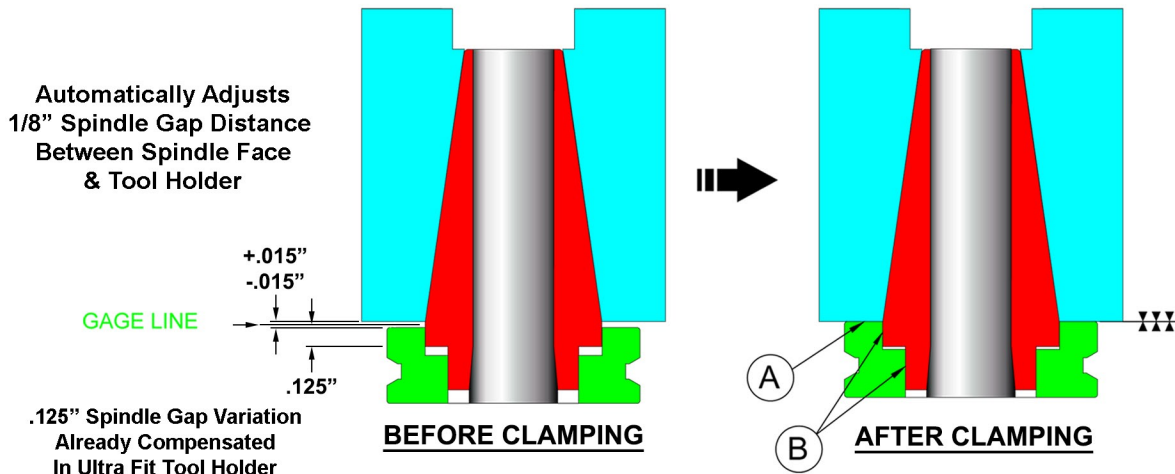

This system is extremely rigid when fully seated in the machine and has 100% full contact with the machine spindle and face. All axial and lateral forces are transmitted from the tool to the spindle minimizing cutting vibration and extending cutting tool life. The primary forces are transmitted from surface A and surface B which is perpendicular to surface A. The ULTRA FIT system eliminates chatter of cutting tools when using long reach tooling or from heavy roughing applications.

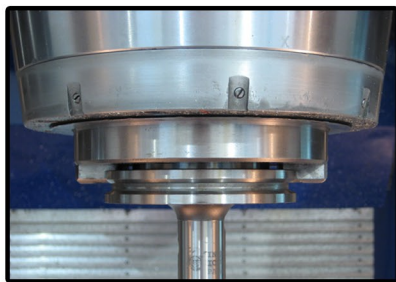

STANDARD HOLDERS

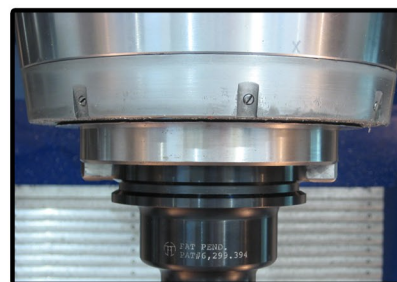

ULTRA FIT HOLDERS

ULTRA FIT BENEFITS

- Dual Contact On Spindle Taper & Face
 - Up To 25% Feed Rate Increases or More
 - Increase Rigidity & Stability
 - Decrease Vibration & Chattering
 - Increase Tooling Life & Accuracy
 - Auto Adjusting
- (No Assembly or Machining Required On Spindle)

No additional assembly or machining is needed on the spindle which is required with other dual contact holders in the market.



ULTRA FIT: CAT 40 V-INTERLOC MASTER UNIT

* Assembles with IXS shanks *

**"INTERLOC DRIVE SYSTEM"
WITH
"ULTRA FIT SYSTEM"**



"ULTRA FIT"
INTERLOC
CAT 40V
FLANGE

SHANK SIZE
DIAMETER

UFC4V-S750

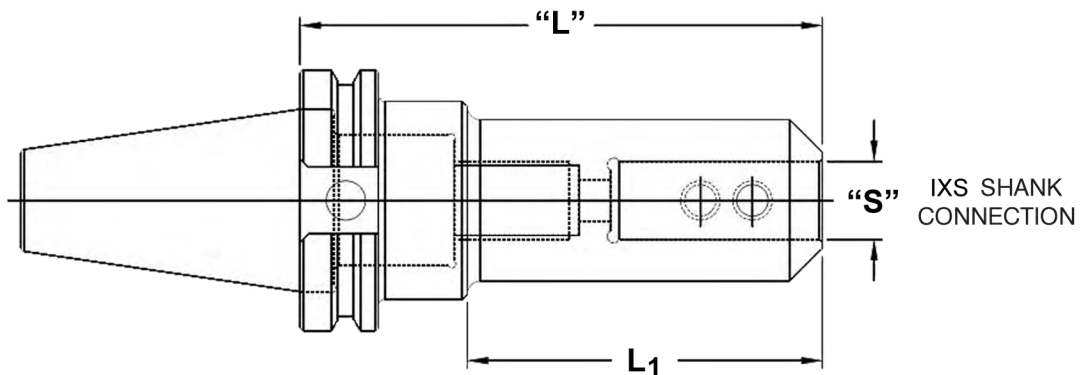

CONNECTS WITH IXS SHANKS (IXS SHANKS PAGES 10-11)

❖ *Cooling through shanks available*

▲ *Custom lengths available*

CATALOG NUMBER	SHANK SIZE (S)	LENGTH (L)	LENGTH (L ₁)	LOCK SCREW NUMBER	"T" HANDLE ALLEN WRENCH
UFC4V-S750	0.750	5.000	3.400	TS-375	3/16
UFC4V-S100	1.000		4.250	TS-500S	1/4
UFC4V-S125	1.250				

ULTRA FIT: CAT 40 V-INTERLOC HOLDER

* Assemblies with extensions, reducers, endmill holders and cutterheads *

**"INTERLOC DRIVE SYSTEM"
WITH
"ULTRA FIT SYSTEM"**



"ULTRA FIT"
INTERLOC
CAT 40V
FLANGE

TAPER (or "S" for straight)
STYLE

UFC4V-F100T-65

INTERLOC
"F" - FEMALE
CONNECTION

LENGTH
"L"

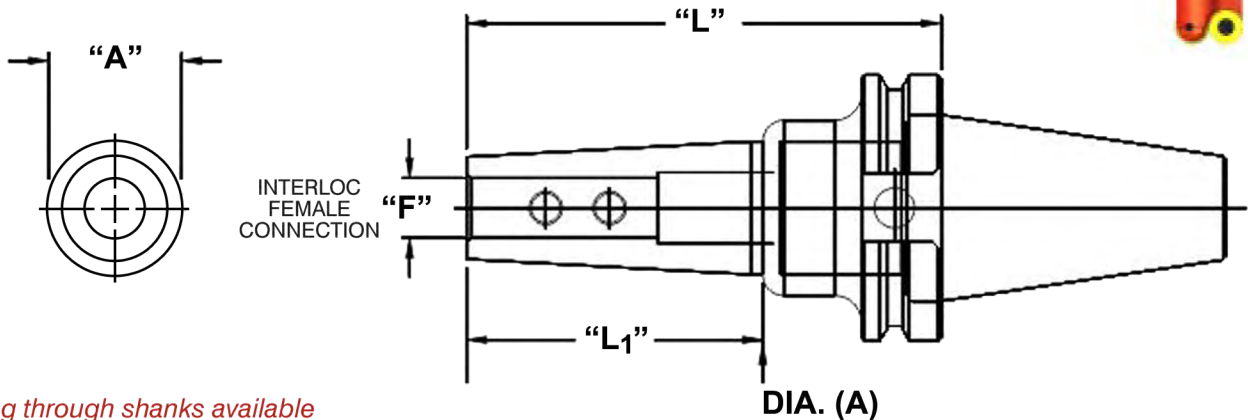
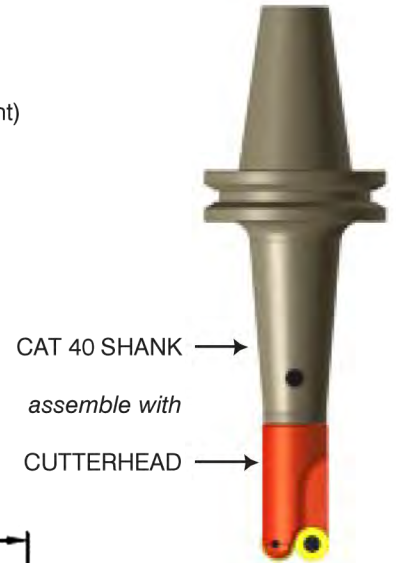

❖ Cooling through shanks available

▲ Custom lengths available

CATALOG NUMBER	FEMALE CONNECTION (F)	DIAMETER (A)	LENGTH (L)	LENGTH (L ₁)	LOCK SCREW NUMBER	"T" HANDLE ALLEN WRENCH
UFC4V-F75T-45	F75 INTERLOC	1.062	4.500	2.750	TS-250S	1/8
UFC4V-F75T-55			5.500	3.750		
UFC4V-F75T-65			6.500	4.750		
UFC4V-F100T-45	F100 INTERLOC	1.250	4.500	2.750	TS-516S	5/32
UFC4V-F100T-55			5.500	3.750		
UFC4V-F100T-65			6.500	4.750		
UFC4V-F125T-45	F125 INTERLOC	1.480	4.500	2.750	TS-516S	5/32
UFC4V-F125T-55			5.500	3.750		
UFC4V-F125T-65			6.500	4.750		
UFC4V-F200S-45	F200 INTERLOC	1.900	4.500	3.750	TS-375	3/16
UFC4V-F200S-525			5.500	4.500		
UFC4V-F200S-625			6.500	5.500		

ULTRA FIT: CAT 50 V-INTERLOC MASTER UNIT

* Assembles with IXS shanks *

**"INTERLOC DRIVE SYSTEM"
WITH
"ULTRA FIT SYSTEM"**



"ULTRA FIT"
INTERLOC
CAT 50V
FLANGE

SHANK SIZE
DIAMETER

UFC5V-S750

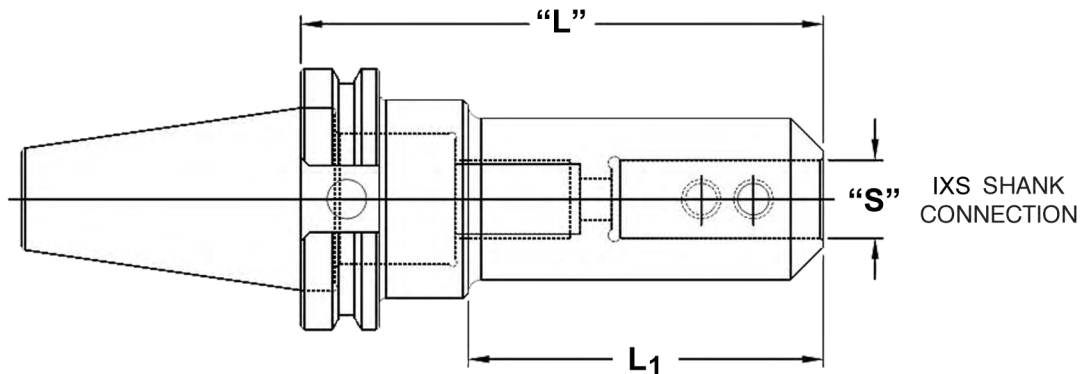
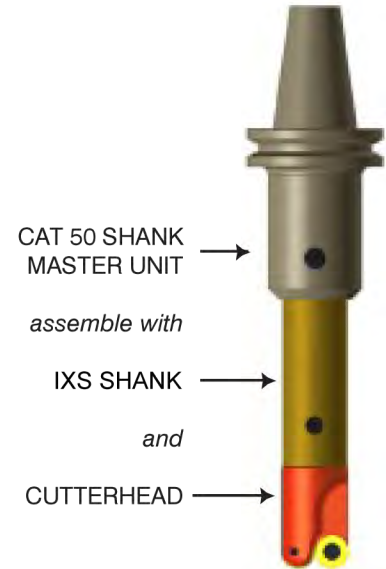

CONNECTS WITH IXS SHANKS (IXS SHANKS PAGES 10-11)

❖ *Cooling through shanks available*

▲ *Custom lengths available*

CATALOG NUMBER	SHANK SIZE (S)	LENGTH (L)	LENGTH (L ₁)	LOCK SCREW NUMBER	"T" HANDLE ALLEN WRENCH
UFC5V-S750	0.750	6.000	4.000	TS-375	3/16
UFC5V-S100	1.000			TS-500S	1/4
UFC5V-S125	1.250				

ULTRA FIT: CAT 50 V-INTERLOC HOLDER

* Assemblies with extensions, reducers, endmill holders and cutterheads *

**"INTERLOC DRIVE SYSTEM"
WITH
"ULTRA FIT SYSTEM"**



"ULTRA FIT"
INTERLOC
CAT 50V
FLANGE

TAPER (or "S" for straight)
STYLE

UFC5V-F100T-65

INTERLOC
"F" - FEMALE
CONNECTION

LENGTH
"L"

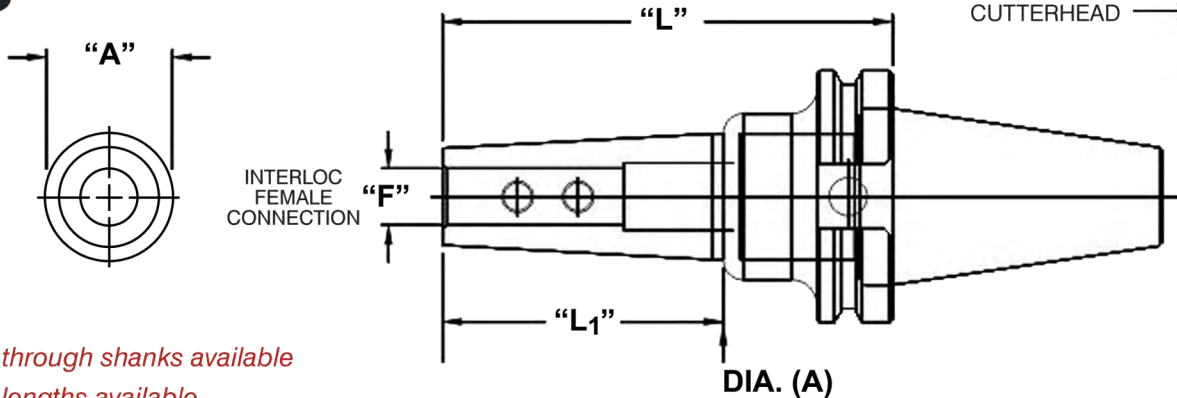

❖ Cooling through shanks available

▲ Custom lengths available

CATALOG NUMBER	FEMALE CONNECTION (F)	DIAMETER (A)	LENGTH (L)	LENGTH (L ₁)	LOCK SCREW NUMBER	"T" HANDLE ALLEN WRENCH
UFC5V-F100T-525	F100 INTERLOC	1.480	5.250	3.250	TS-516	5/32
UFC5V-F100T-65			6.500	4.500		
UFC5V-F100T-85			8.500	6.500		
UFC5V-F100T-105			10.500	8.500		
UFC5V-F125T-525	F125 INTERLOC	1.460	5.250	3.250		
UFC5V-F125T-65			6.500	4.500		
UFC5V-F125T-85		1.400	8.500	6.500		
UFC5V-F125T-105		1.700	10.500	8.500		
UFC5V-F200T-525	F200 INTERLOC	2.740	5.250	3.250	TS-375	3/16
UFC5V-F200T-65			6.500	4.500		
UFC5V-F200T-85			8.500	6.500		
UFC5V-F200T-105			10.500	8.500		
UFC5V-F200S-525		1.900	5.250	3.250		
UFC5V-F200S-65			6.500	4.500		
UFC5V-F200S-85			8.500	6.500		
UFC5V-F200S-105			10.500	8.500		

ULTRA FIT: CAT 40 FACE MILL HOLDER

* Assembles with facemill *

"ULTRA FIT SYSTEM"

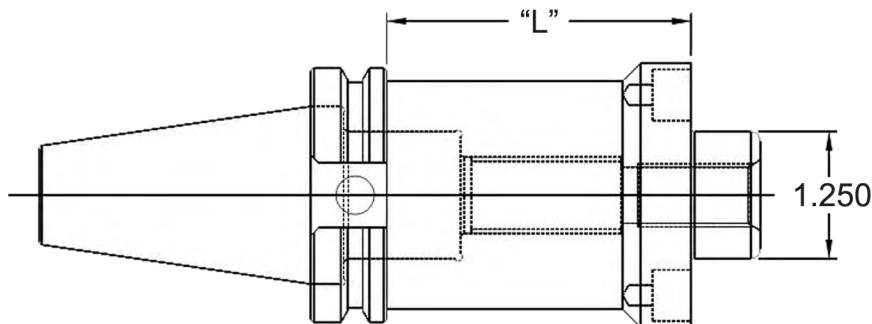

❖ Cooling through shanks available

▲ Custom lengths available

CATALOG NUMBER	LENGTH (L)	PILOT
UFC4V-125SME-30	3.000	1.250
UFC4V-125SME-40	4.000	
UFC4V-125SME-50	5.000	

ULTRA FIT: CAT 50 FACE MILL HOLDER

* Assembles with facemill *

"ULTRA FIT SYSTEM"

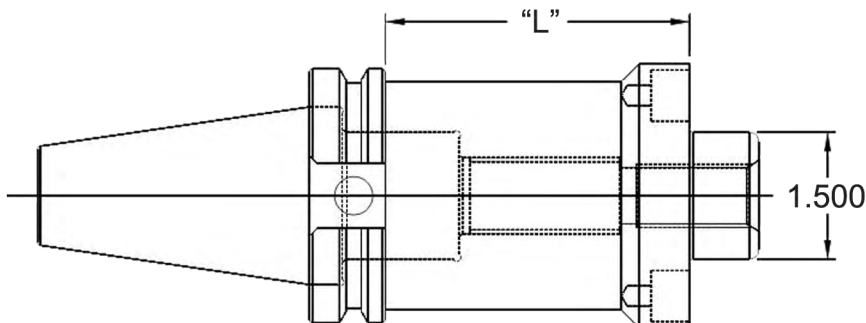

❖ Cooling through shanks available

▲ Custom lengths available

CATALOG NUMBER	LENGTH (L)	PILOT
UFC5V-150SME-35	3.500	1.500
UFC5V-150SME-45	4.500	
UFC5V-150SME-55	5.500	

