

INTERLOC-STRAIGHT SHANKS

* Assembles with extensions, reducers, endmill holders and cutterheads *

"INTERLOC DRIVE SYSTEM"



INTERLOC EXTENSION SHANK
IXS-F75S-45U
 STRAIGHT STYLE
 LENGTH "L"
 INTERLOC "F" - FEMALE CONNECTION
 UNIVERSAL TOOL
 • INTERLOC SHANK STYLE OR WELDON FLAT HOLDING

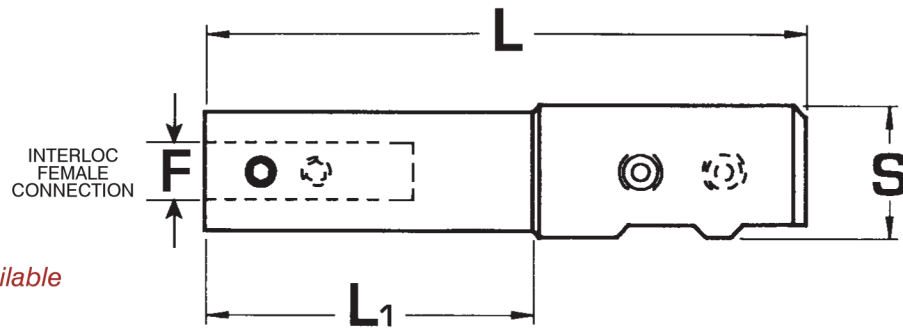
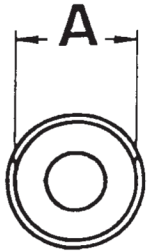
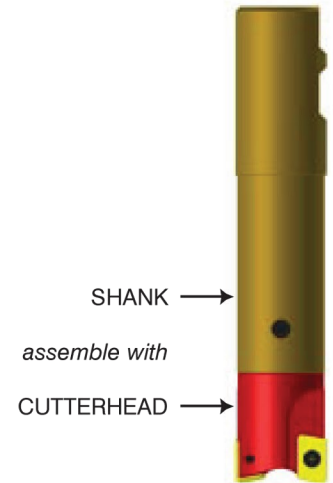

- ❖ Cooling through shanks available
- * Semi-special
- ▲ Custom lengths available

CATALOG NUMBER	INTERLOC FEMALE CONNECTION (F)	DIAMETER (A)	SHANK DIAMETER (S)	LENGTH (L)	LENGTH (L1)	LOCK SCREW NUMBER	"T" HANDLE ALLEN WRENCH
IXS-F75S-35U*	F75 INTERLOC	.710	.750	3.500	1.200	TS-250S	1/8
IXS-F75S-45U				4.500	2.200		
IXS-F75S-575U				5.750	3.000		
IXS-F75S-75U				7.500	5.200		
IXS-F100S-35U*	F100 INTERLOC	.950	1.000	3.500	1.200	TS-516S	5/32
IXS-F100S-45U				4.500	2.200		
IXS-F100S-60U				6.000	3.500		
IXS-F100S-75U				7.500	4.500		
IXS-F125S-45U	F125 INTERLOC	1.200	1.250	4.500	2.200	TS-516	5/32
IXS-F125S-60U				6.000	3.500		
IXS-F125S-75U				7.500	4.750		
IXS-F125S-95U				9.500	6.500		
IXS-F200S-50U	F200 INTERLOC	1.900	2.000	5.000	1.700	TS-375	3/16
IXS-F200S-70U				7.000	3.700		
IXS-F200S-90U				9.000	5.700		

INTERLOC-TAPER REACH SHANKS

* Assembles with extensions, reducers, endmill holders and cutterheads *

"INTERLOC DRIVE SYSTEM"

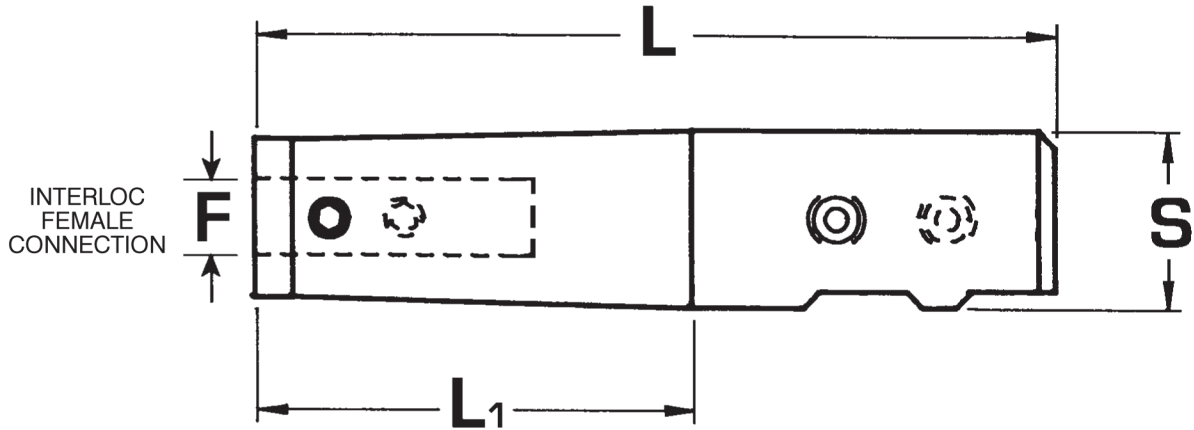
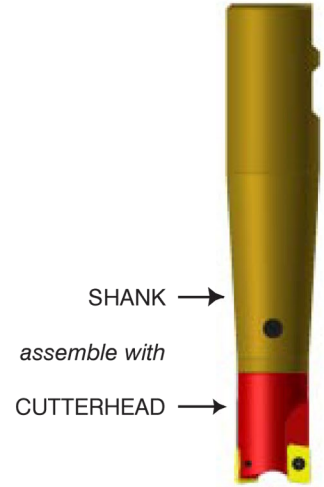
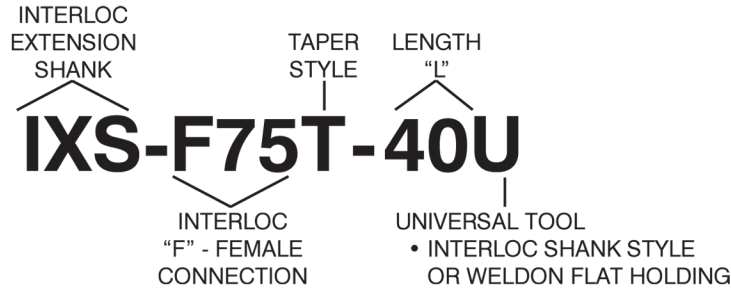

❖ Cooling through shanks available

▲ Custom lengths available

CATALOG NUMBER	INTERLOC FEMALE CONNECTION (F)	SHANK DIAMETER (S)	LENGTH (L)	LENGTH (L ₁)	LOCK SCREW NUMBER	"T" HANDLE ALLEN WRENCH
IXS-F75T-40U	F75 INTERLOC	1.000	4.000	1.750	TS-250S	1/8
IXS-F75T-50U			5.000	2.700	TS-250	
IXS-F75T-60U			6.000	3.500	TS-250S	
IXS-F75T-70U			7.000	4.650		
IXS-F75T-80U			8.000	5.650		
IXS-F100T-50U	F100 INTERLOC	1.250	5.000	2.600	TS-516	5/32
IXS-F100T-60U			6.000	3.400	TS-516S	
IXS-F100T-75U			7.500	4.800		
IXS-F100T-95U			9.500	6.650		