

Introducing:

Troy Industries Indexable Detail Cutters:

Indexable Cutters With Smaller Cutting Diameters
Available In .375", .500", & .625" Diameter Cutting Sizes

Semi-Finishing & Finishing Applications

Back-Draft For Superior Finishes

100% American Made

Perfect For:

Contour Milling

Left Over Machining

Deep Narrow Pockets Milling

Available With 1/8", 1/16" or 1/32" Insert Radius

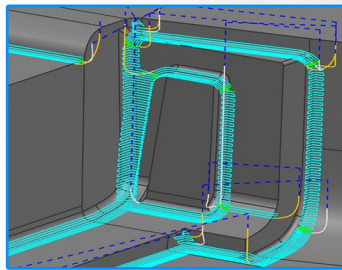
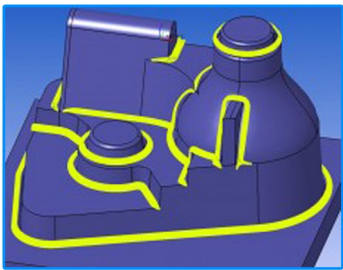

Serving Various Industries:

ISO 9001:2008 Duns #: 095401048 Cage Code: 5KUJ9



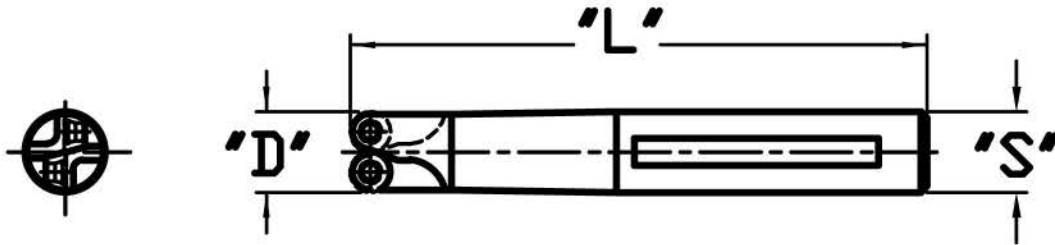

1/8" Insert Radius

Catalog #	Cutting Dia. (D)	Length (L)	Shank Dia. (S)	# of Flutes	Insert #	Insert Screw #	Torx Wrench
50RPG-21-60	0.500	6.000	0.500	2	RPG-21	TS-21	T-8

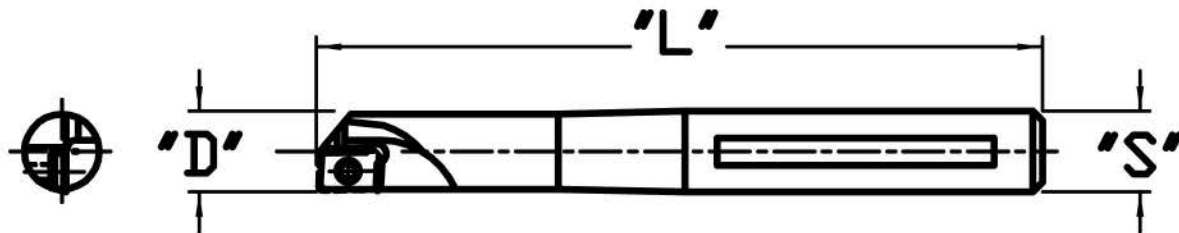
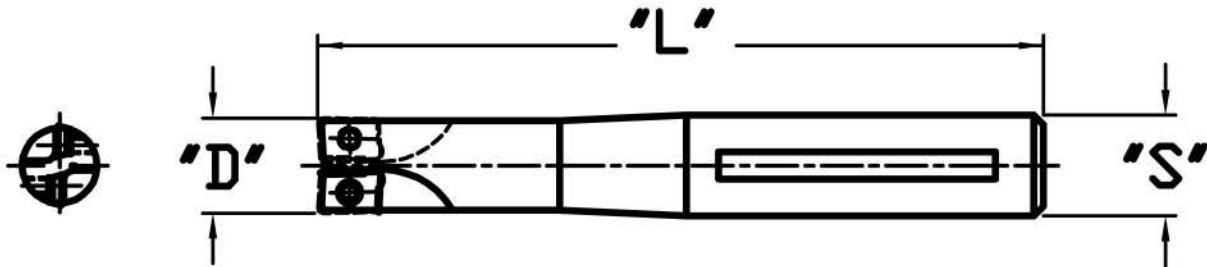

Available With 1/16" or 1/32" Insert Radius

Catalog #	Cutting Dia. (D)	Length (L)	Shank Dia. (S)	# of Flutes	Insert #	Insert Screw #	Torx Wrench
38B-CDE-60	0.375	6.000	0.375	1	CDEW-834	TS-21	T-8
50B-CDE-60	0.500		0.500				
58-CDE-60	0.625		0.625	2		TS-625	